

1 PLAN VIEW  
SCALE: 6"=1'-0"

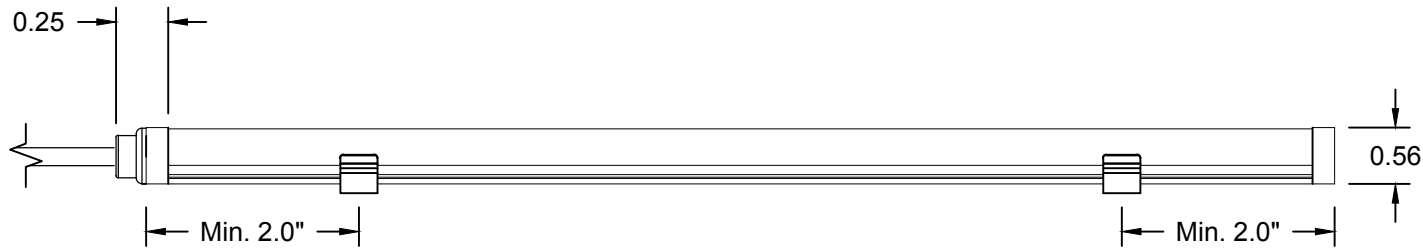

2 ELEVATION VIEW  
SCALE: 6"=1'-0"

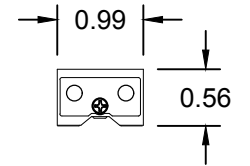

3 END CAP  
SCALE: 6"=1'-0"

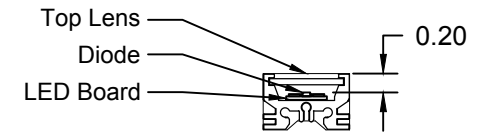

4 SECTION  
SCALE: 6"=1'-0"

## TECHNICAL DATA

Parameter	Data
Power	4 or 8 watts per linear foot
Input Voltage	90-120VAC
Input Current per Linear Ft	45mA@4W, 70mA@8W
Control	Leading-edge/Trailing-edge line dimmer
Power Cable Length	UL Standard 6ft
LED Spacing	5/8" on center
Fixture Length	12"-72", in 4" increment
Fixture Width	0.99"
Total Height (not including clip)	0.56"
Mounting	Fixed Clip
Available Optics	120°
Finish Options	Clear Anodized Aluminum
LED Color Options	24K, 27K, 30K, 35K, 40K, 50K
Color Rendering Index	90+ CRI
Ratings	Dry
Total linear ft per 20A breaker	330ft@4W or 210ft@8W
Total linear ft per 15A breaker	247ft@4W or 157ft@8W
Total linear ft per power feed	84ft@4W or 54ft@8W
Transformer	N/A

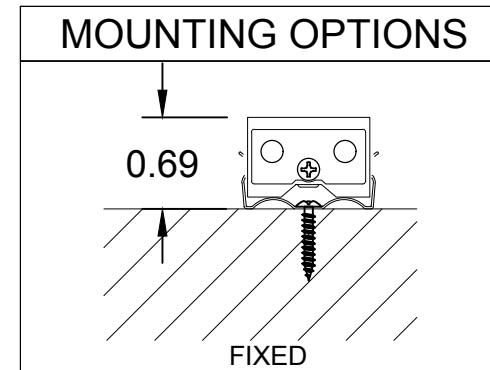

**BOCA  
FLASHER**

LED Lighting Systems, Technologies & Manufacturing

508 SO. MILITARY TRL. DEERFIELD BEACH, FL 33442

www.bocafasher.com  
(561) 989-5338

**NICHE-HV**

FILE NAME: TECHNICAL SHEET PART #: NICHE-HV

DRAWN BY: ANGELA TODD 04 / 26 / 13

DESIGN BY: LUIS ROSADO

APPROVED BY: ANGELA TODD

SCALE: NTS SHEET: 1 OF 1

THIS DOCUMENT IS CONFIDENTIAL AND PROTECTED BY COPYRIGHTS OF BOCA FLASHER INC.