

1 PLAN VIEW
SCALE: 6"=1'-0"

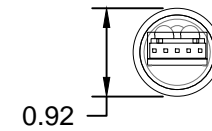

4 SIDE VIEW IN TUBE
SCALE: 6"=1'-0"

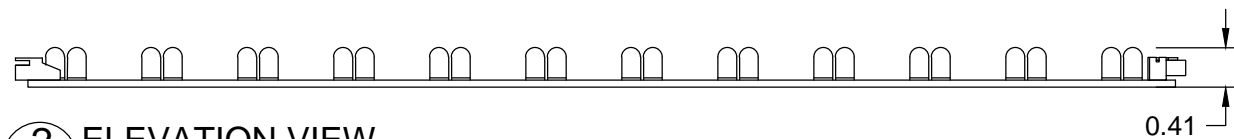

2 ELEVATION VIEW
SCALE: 6"=1'-0"

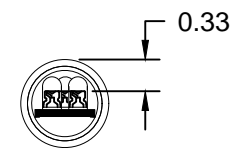

5 SECTION
SCALE: 6"=1'-0"

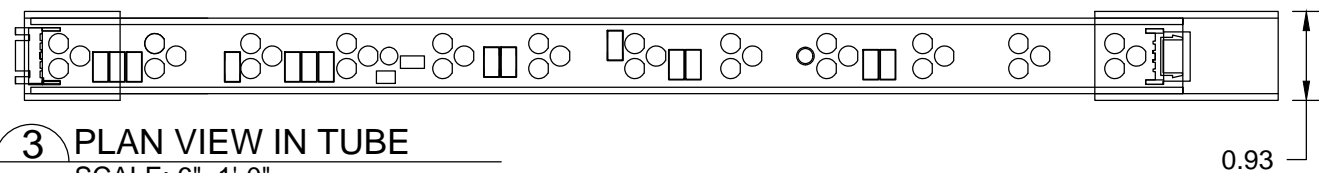

3 PLAN VIEW IN TUBE
SCALE: 6"=1'-0"

TECHNICAL DATA

Wattage	4 watts per linear foot
Input Voltage	24VRAC or 24VDC
Input Current	150mA RMS per linear ft
Control	DMX 512 Input
Home Run Cable Length	25ft, 35ft or 45ft (Job Specific)
LED Spacing, per strip	1" on center
Fixture Length	6" or 8" increments
Fixture Width	0.62"
Total Height (not including tube)	0.41"
Mounting	Tube, Underwater Tube, No Tube
Available Optics	Color: 30°, 120° -- White: 15°, 50°, 120°
Color Options	RGB, White Color Mixing
Color Rendering Index (CRI)	80 CRI
Ratings	Dry, IP65, IP68
Total linear ft per 20A breaker	420 feet
Total linear ft per 15A breaker:	300 feet
Total linear ft per power feed	10 feet
Transformer	Primary 120V or 277V, Secondary 24V

MOUNTING OPTIONS

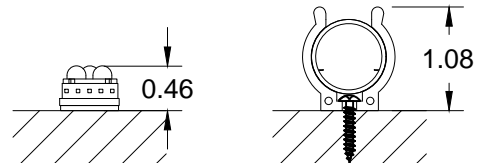

MOUNTING TAPE

TUBE

(fixture can rotate in tube)



LED Lighting Systems, Technologies & Manufacturing

552 N.W. 77TH ST
BOCA RATON, FL 33487

www.bocaflasher.com
(561) 989-5338

THIS DOCUMENT IS CONFIDENTIAL AND PROTECTED BY COPYRIGHTS OF BOCA FLASHER INC.

CCS 100

FILE NAME:	TECHNICAL SHEET	PART #:	CCS100
DRAWN BY:	DEMMLER FILLINGER	04 / 24 / 13	
DESIGN BY:	LUIS ROSADO		
APPROVED BY:	STEPHANIE BURKE		
NTS	1 OF 1		